

# HI 727

## Color of Water

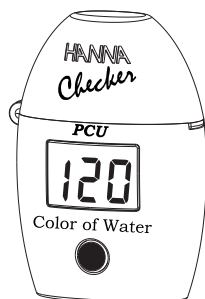

**HANNA**  
instruments  
www.hannainst.com

Dear Customer,

Thank you for choosing a Hanna Instruments Product.

Please read this instruction manual carefully before using the instrument. If you need additional technical information, do not hesitate to e-mail us at [tech@hannainst.com](mailto:tech@hannainst.com) or view our worldwide contact list at [www.hannainst.com](http://www.hannainst.com).

### Preliminary examination:

Please examine this product carefully. Make sure that the instrument is not damaged. If any damage occurred during shipment, please notify your Dealer.

Each HI 727 meter is supplied complete with:

- Two Sample Cuvettes and Caps
- 1 x 1.5V AAA Battery
- Instruction Manual



**For more details about spare parts and accessories see "Accessories".**

### Technical specifications:

Range	0 to 500 PCU
Resolution	5 PCU
Accuracy	±10 PCU ±5% of reading @ 25 °C / 77 °F
Light Source	Light Emitting Diode @ 470 nm
Light Detector	Silicon Photocell
Method	Adaptation of the Standard Methods for the Examination of Water and Wastewater 21 <sup>th</sup> edition, Colorimetric Platinum Cobalt method.
Environment	0 to 50 °C (32 to 122 °F); max 95% RH non-condensing
Battery Type	1 x 1.5V AAA
Auto-Shut off	After 2 minutes of non-use
Dimensions	81.5 x 61 x 37.5 mm (3.2 x 2.4 x 1.5")
Weight	64 g (2.25 oz.)

### Functional description:

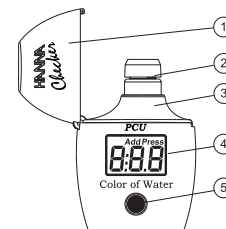

1. Cuvette cap.
2. Cuvette with cap.
3. Cuvette holder.
4. Liquid Crystal Display.
5. Button.

### Errors and warnings:

L.H.

**Light High:** There is too much light to perform a measurement. Please check the preparation of the zero cuvette.

L.Lo

**Light Low:** There is not enough light to perform a measurement. Please check the preparation of the zero cuvette.

Inv

**Inverted Cuvettes:** The sample and the zero cuvette are inverted.

0

**Under Range:** A blinking "0" indicates that the sample absorbs less light than the zero reference. Check the procedure and make sure you use the same cuvette for reference (zero) and measurement.

500

**Over Range:** A flashing value of the maximum concentration indicates the reading is over range. Dilute the sample and re-run the test.

bAt

**Battery Low:** The battery must be replaced soon.

bAd

**Dead Battery:** This indicates that the battery is dead and must be replaced. Once this indication is displayed, normal operation of the instrument will be interrupted. Change the battery and restart the meter.

bAt

### Measurement procedure:

- Turn the meter on by pressing the button. All segments will be displayed. When the display shows "Add", "C.1" with "Press" blinking, the meter is ready.
- Fill one cuvette up to the 10 mL mark with deionized water and replace the cap. This is the blank.
- Place the blank cuvette into the meter and close the meter's cap.
- Press the button. When the display shows "Add", "C.2" with "Press" blinking the meter is zeroed.
- Fill second cuvette up to the 10 mL mark with unfiltered sample and replace the cap. This is the apparent color.
- Insert the apparent color cuvette into the meter and close the meter's cap.
- Press the button and the meter directly displays the value of apparent color.
- Remove the cuvette and press the button twice to restart the meter.
- Filter 50 mL of sample through a 0.45 µm membrane filter into a beaker.
- After measuring of apparent color rinse the cuvette three times with filtered sample and then fill it up to the 10 mL mark with the filtered sample and replace the cap. This is the true color.
- Follow the procedure above to re-zero the meter using the blank cuvette.
- Insert the true color cuvette into the instrument.
- Press the button and the meter directly displays concentration in color units of the true color on the LCD. The meter automatically turns off after 2 minutes.

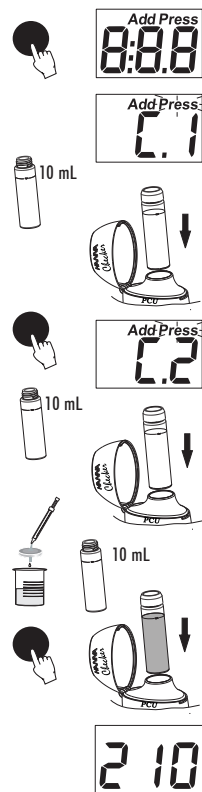

### Tips for an accurate measurement

- It is important that the sample does not contain any debris.
- Whenever the cuvette is placed into the measurement cell, it must be dry outside, and completely free of fingerprints, oil and dirt. Wipe it thoroughly with HI 731318 or a lint-free cloth prior to insertion.
- Shaking the cuvette can generate bubbles, causing higher readings. To obtain accurate measurements, remove bubbles by swirling or by gently tapping the cuvette.
- Do not let the reacted sample stand for too long after reagent is added, as accuracy will be affected.
- After the reading it is important to immediately discard the sample, otherwise the glass might become permanently stained.

### Battery management

- To save the battery, the instrument shuts down after 2 minutes of non-use. One fresh battery lasts for a minimum of 5000 measurements. When the battery is dead the instrument will display "bAd" then "bAt" for 1 second and then turns off. To restart the instrument, the battery must be replaced with a new one. To replace the instrument's battery:
- Turn the instrument off by holding the button until the meter shuts off.
  - Turn the instrument upside down and remove the battery cover with a screwdriver.

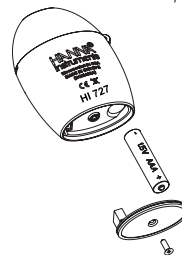

- Remove the battery from its location and replace it with a new one, inserting the negative end first.
- Insert the battery cover and replace the screw with a screwdriver.

### Accessories:

#### REQUIRED ACCESSORIES

0.45 µm membrane filter for true color measurement.

#### OTHER ACCESSORIES

HI 727-11	Color of Water Certified Standard Kit
HI 731318	Cloth for wiping cuvettes (4 pcs.)
HI 731321	Glass cuvettes (4 pcs.)
HI 731225	Cuvette black cap for checker HC (4 pcs.)
HI 731353	Cuvette seal cap for checker HC (4 pcs.)
HI 740028	1.5V AAA batteries (4 pcs.)
HI 93703-50	Cuvette cleaning solution (230 mL)

#### Recommendations for Users

Before using this product, make sure that it is entirely suitable for your specific application and for the environment in which it is used. Operation of this instrument may cause unacceptable interferences to other electronic equipment, thus requiring the operator to take all necessary steps to correct interferences. Any variation introduced by the user to the supplied equipment may degrade the instrument's EMC performance. To avoid damage or burns, do not put the instrument in microwave oven. For the safety of you and the instrument do not use or store the instrument in hazardous environments.

Hanna Instruments reserves the right to modify the design, construction or appearance of its products without advance notice.

**For additional information, contact your dealer or the nearest Hanna Customer Service Center. To find a Hanna Office in your area, visit our web site:**

[www.hannainst.com](http://www.hannainst.com)

